

# imants<sup>®</sup>

Digging the future



**15 cm (6")**

Minimum spading depth

**35 cm (14")**

Maximum spading depth (SX)

**55 cm (21")**

Maximum ripping depth (WX)

## SX-Series Agriculture

- Time saving
- Good mixing
- Improves water balance
- Incorporates organic material
- Seedbed in one pass
- Robust build quality
- Preserves soil structure
- Elimination of compactions
- Fuel saving
- Cost effective
- No hard pan
- All-round machine

THE PHILOSOPHY

# Spading is more than just turning the soil

More than 60 years of experience with spading machines is something Imants can look back on. From that experience we learned spading is more than just turning soil. Much more, in fact. Spading means mixing organic material with the living topsoil, incorporating crop residues and creating a seedbed, mixing green manure so it can be broken down into nutrients for the next crop.

In short, both above the ground and in the soil you will achieve an even, homogeneous and well aerated soil after tillage with Imants spading machines. The true one pass tillage tool.



Tillage spader with harrow



No hard pan



Oxygen



Water holding capacity

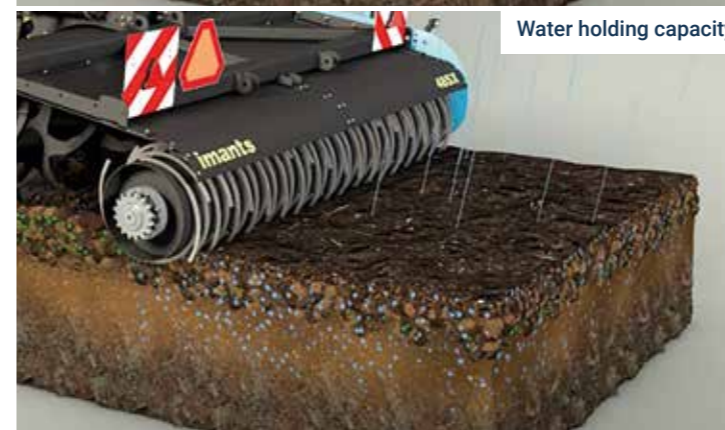

ADVANTAGES OF SPADING

# Imants spading machines take care of your soil

The rotating movement of the spade shaft with spades ensures an optimal mixing effect. Because of this, crop residues, manure, compost or green manure can be mixed with the soil into the most biologically active layer so that they can be quickly decomposed.

**The rotational movement of the spade shaft with spades ensures an optimal mixing effect.**

Crop residues or green manure do not form a sillage layer at the bottom of the soil. Because of this mixing the soil life can also benefit from the freshly applied organic material.

Since the spades take soil bites of 25 to 30 cm (10 - 12 inch) and pull these from the underlying soil layer, an impermeable disturbing layer is not created at the bottom, the so-called plow pan. This means that precipitation can penetrate into the deeper soil layers and replenish the groundwater. The good structure that remains after spading not only allows water to penetrate, but also ensures a good oxygen level.



Because spading machines do not form a hard pan in the soil, capillary action remains intact, so rising groundwater can reach the roots of plants when they need it. During spading, the subsoil is mixed, but not completely turned over. This preserves most of the soil temperature, reducing the time it takes for the soil to warm up. This results in faster germination. The deeper soil layers are given time enough to warm up as the plants grow.

**With an Imants spading machine, the soil can be made ready for sowing or planting in 1 pass.**

With an Imants rotary spader, the soil can be made ready for sowing or planting in one operation. The driven power harrow leaves an ideal seedbed. By combining operations you not only save time and money but also the soil structure (see combining passes p. 16).

SX SPADING TECHNIQUE

# The design of the SX-spading machine

The SX spading machines from Imants are rotary spading machines. They work the soil by means of spades which are attached to the spading shaft via a steel arm. On the 38 Series, 4 spade arms create a bank, the 48 & 58 Series have 6 spade arms per bank. The number of spades on the spade shaft varies according to the working width.

**The SX-spadingblade**  
For use on all soil types except wet clay. The spading blades are easy to replace.

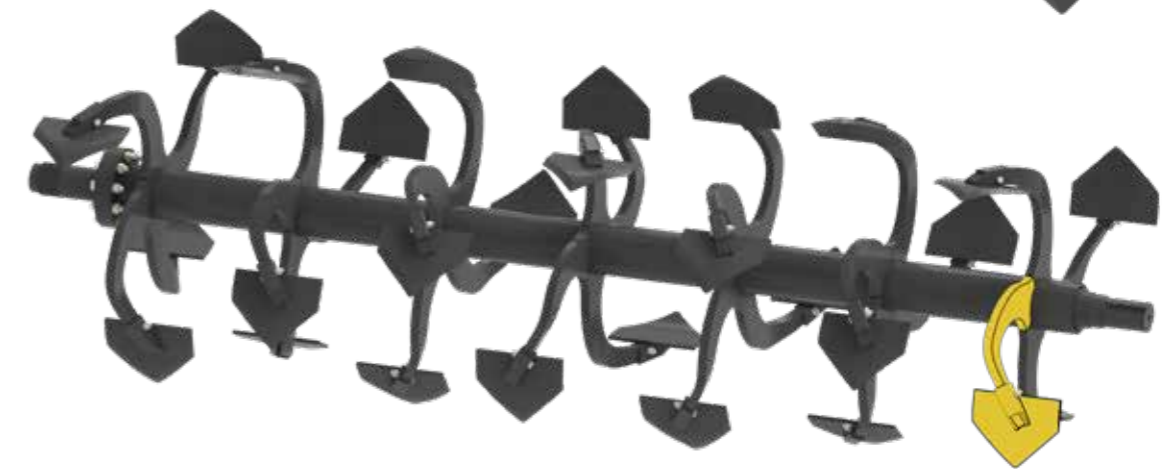

Depending on what you need on your farm Imants can recommend the right spading machine. There are spading machines that can work shallowly (12 cm (5") deep) but as well as very deep (up to 135 cm (53") is possible.

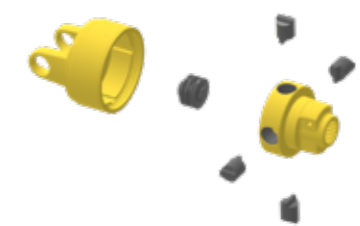

◀ All spading machines are equipped with a torque limiting clutch for protection.



Digging  
the  
future

SX-MODELS

## SX-series possibilities and specifications

### 38 Series

**Power**  
95 - 190 hp

**Working width**  
250, 270 or 300 cm  
8', 9' or 10'



### 48 Series

**Power**  
140 - 300 hp

**Working width**  
300 or 366 cm  
10' or 12'



### 58 Series

**Power**  
> 230 hp

**Working width**  
300, 366 and 450 cm  
10', 12' and 15'



DEEPER TILLAGE

# Subsoiling, yes or no?

## SX Series

The SX-Series has a minimum working depth of 15 cm (6"), with a maximum of 35 cm (14"). The blades loosen the soil over the entire working width and mix manure, green manure or plant residues through the most biologically active part of the soil.

## WX Series

The WX-Series is equipped with adjustable ripper legs between the banks, which can loosen the soil deeper than the spading depth. The WX-Series has fewer spading blades than the comparable SX-Series version, but the soil is still worked across the full working width. The ripper shanks loosen compacted layers of soil below the working depth of the spade shaft so that roots can also penetrate deeper into the soil resulting in a higher yield.



CONSOLIDATION

# What finish would you like to have?

## Driven power harrow

The Imants 38, 48 and 58 series spading machines can be equipped with a driven power harrow. This harrow breaks up the top layer and ensures a fine and even seedbed. It is the ideal roller for sandy and loamy soils.



## Ringroller

The ringroller with a diameter of 60 or 80 cm (24 or 31") leaves a coarser seedbed and is suitable for all soil types.



## Prismaroller

For heavier soil types the self-cleaning prismaroller is recommended. This roller consolidates and culti-packs the soil so that an even, flat and firm seed bed is left behind.

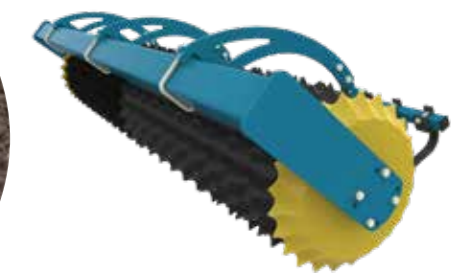

# Digging the future



**imants**  
Digging the future

SX/WX OPTIONS

# Options for all SX/WX models

To make the SX/WX-Series spading machines fit your needs, you can choose from a number of options. You can not only choose from a number of different finishing rollers, but also from different types of hitches for mounting seeders or planters or different types of towed implements (drawbar or K80 ball).

**In order to make the SX/WX-Series spading machines fit your needs, you can choose from a number of options.**

In order to prevent crop residues or green manure from dragging on the side plates, the SX/WX-Series spading machines can also be equipped with discs. These guide the organic material towards the spading shaft.

*As illustration, the 48 Series have been chosen. ▶  
Contact us for the options suited for the model of your choice.*

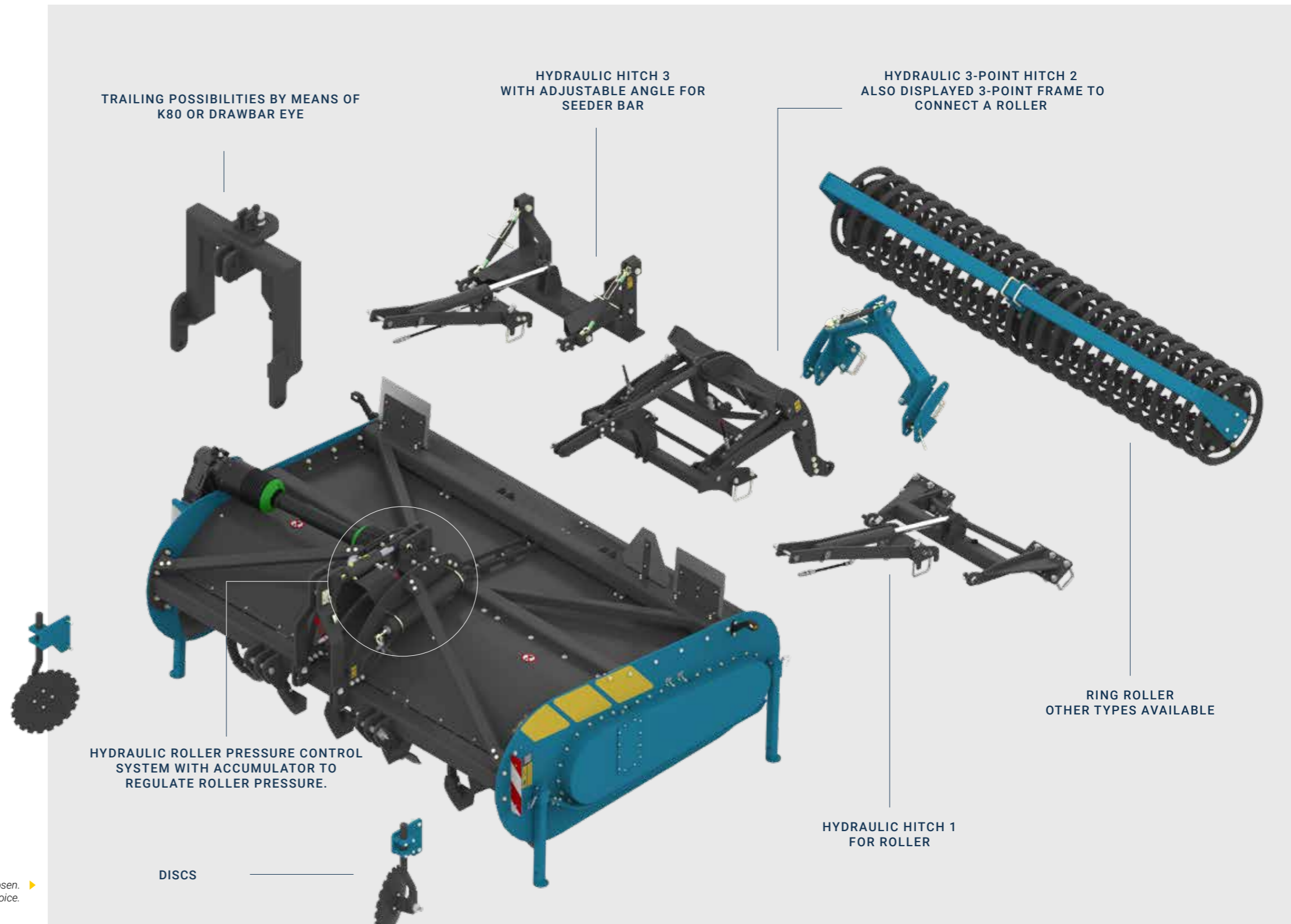

SX/WX OPTIONS

# SX/WX options without power harrow

The SX/WX-Series spading machines without power harrow can be equipped with a clod grid device to further reduce and level the ground that has been spaded. In addition, you can also choose different types of ground driven rollers for these spading machines. In order to attach sowing or planting machines, the spaders can be fitted with a rear hitch.

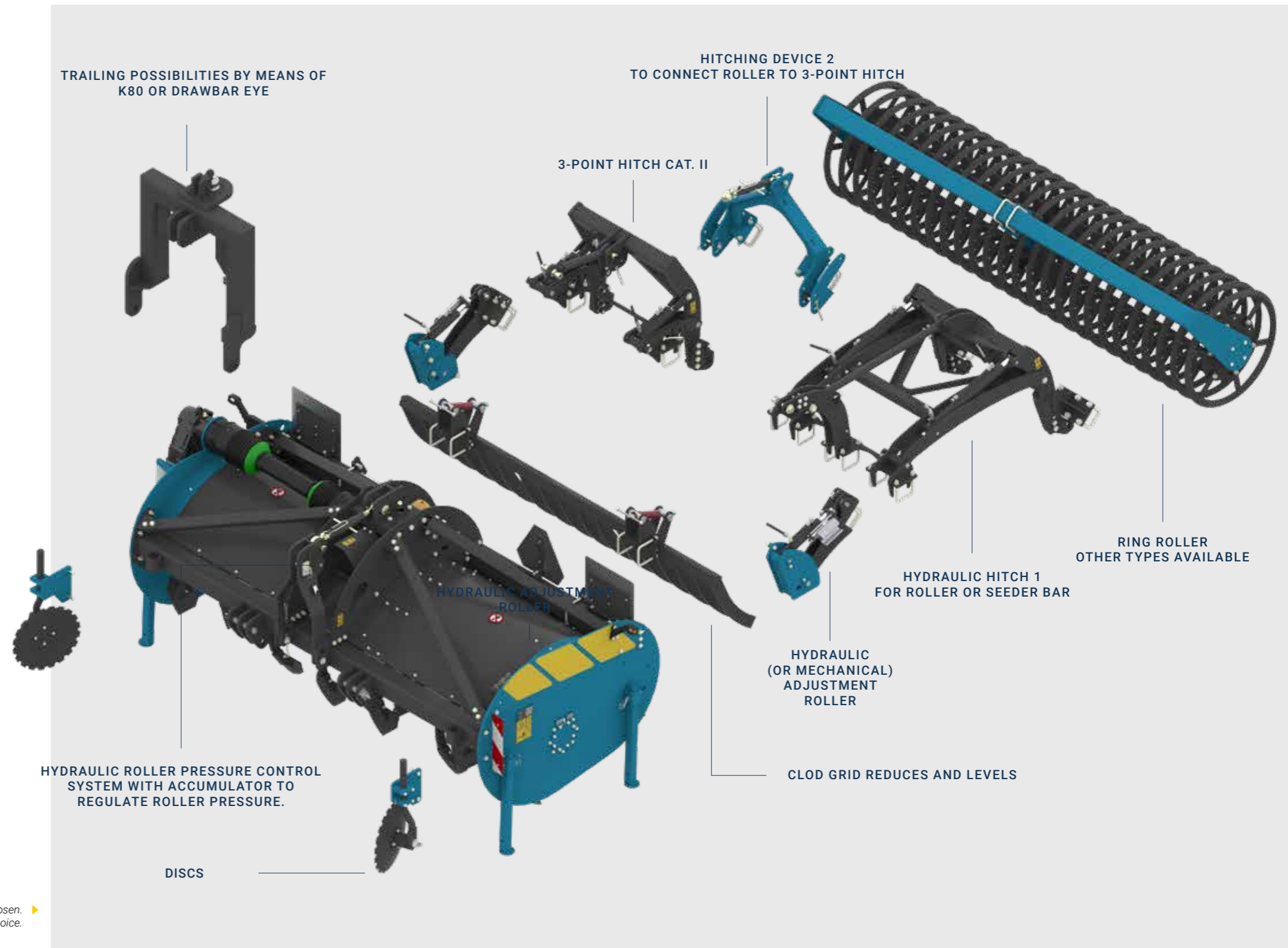

*As illustration, the 48 Series have been chosen. ▶  
Contact us for the options suited for the model of your choice.*

# Digging the future

SX/WX PASSES

## Combining passes

The SX/WX-Series spading machines can be used to prepare the soil for sowing or planting. But the spading machines can also be the heart of a combination allowing you to do all the soil prep and planting in one pass. A (Imants Culter) subsoiler loosens the soil before it is spaded and a seed drill or planter can be mounted or attached to ensure that all operations are done in one pass. Combining not only saves money and time but is also better for your soil. Here you can see some possible combinations.

1. With subsoiler Culter and ringroller
2. With trailed potato planter
3. Mechanical seeder in 3-point
4. Air seeder
5. With ringroller and beet seeder
6. With ringroller as trailing roller

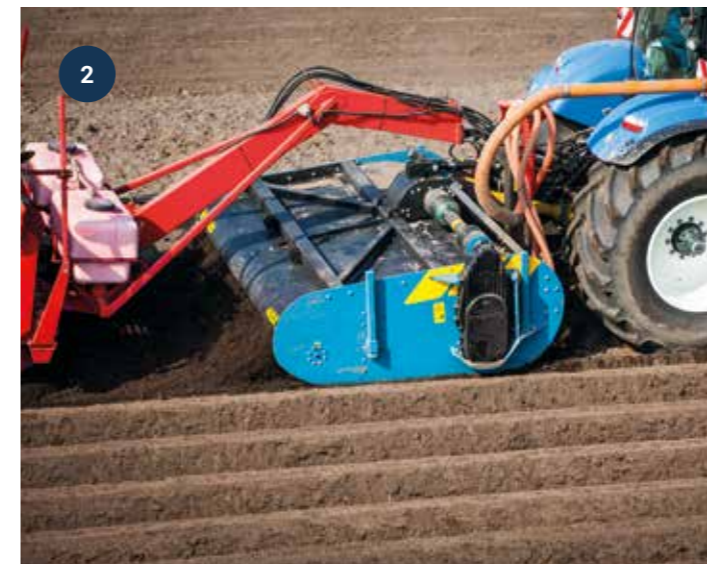

Type	Working width	Total width	# spades	Minimum power (hp)
38SX250H	250cm / 98"	277cm / 108"	24	95
38SX270H	270cm / 105"	297cm / 116"	24	95
38SX300H	300cm / 117"	327cm / 128"	28	95
38SX250	250cm / 98"	277cm / 108"	24	95
38SX300	300cm / 117"	327cm / 128"	28	95
38WX300H	300cm / 117"	327cm / 128"	20	110
38WX300	300cm / 117"	327cm / 128"	20	110
48SX300	300cm / 117"	339cm / 132"	36	140
48SX366	366cm / 143"	405cm / 158"	42	160
48SX300H	300cm / 117"	339cm / 132"	36	140
48SX366H	366cm / 143"	405cm / 158"	42	160
48WX300	300cm / 117"	339cm / 132"	30	150
48WX366	366cm / 143"	405cm / 158"	36	150
48WX300H	300cm / 117"	339cm / 132"	30	150
48WX366H	366cm / 143"	405cm / 158"	36	170
58SX300H	300cm / 117"	331cm / 129"	42	230
58SX366H	366cm / 143"	397cm / 155"	48	230
58SX450H	450cm / 176"	481cm / 188"	60	230
58WX300H	300cm / 117"	331cm / 129"	30	230
58WX366H	366cm / 143"	397cm / 155"	36	230
58WX450H	450cm / 176"	481cm / 188"	48	230
58SX300	300cm / 117"	331cm / 129"	42	200
58SX366	366cm / 143"	397cm / 155"	48	200
58SX450	450cm / 176"	481cm / 188"	60	200
58WX300	300cm / 117"	331cm / 129"	30	200
58WX366	366cm / 143"	397cm / 155"	36	200
58WX450	450cm / 176"	481cm / 188"	48	200

Maximum power (hp)	Weight*	harrow **	Shanks	Other
160	1910kg / 4211lbs	yes	no	Ideal speed***: 5 km/h , 3.1 m/h (1000 rpm)  Spading depth: 15-35 cm (6-14")
160	1990kg / 4387lbs	yes	no	
160	2060kg / 4542lbs	yes	no	
160	1600kg / 3527lbs	no	no	
160	1790kg* / 3946lbs*	no	no	
190	2350kg / 5181lbs	yes	5 pieces	
190	1975kg* / 4354lbs*	no	5 pieces	
250	2170kg / 4784lbs	no	no	Ideal speed ***: 7 km/h , 4.4 m/h (1000 rpm)  Spading depth: 15-35 cm (6-14")
250	2360kg / 5203lbs	no	no	
250	2860kg / 6305lbs	yes	no	
250	3150kg / 6945lbs	yes	no	
300	2430kg / 5357lbs	no	5 pieces	
250	2580kg / 5688lbs	no	6 pieces	
300	3120kg / 6878lbs	yes	5 pieces	
300	3370kg / 7430lbs	yes	6 pieces	
340	3850kg / 8488lbs	yes	no	Ideal speed ***: 6,8 of 9 km/h , 4.3 or 5.5 m/h (1000 rpm)  Spading depth: 15-35 cm (6-14")  There is also a trailed ver- sion available (Carrier).
340	4150kg / 9149lbs	yes	no	
340	4650kg / 10251lbs	yes	no	
400	4100kg / 9039lbs	yes	5 pieces	
400	4400kg / 9700lbs	yes	6 pieces	
400	4900kg / 10803lbs	yes	8 pieces	
340	2750kg / 6063lbs	no	no	
340	3000kg / 6614lbs	no	no	
340	3300kg / 7275lbs	no	no	
400	2950kg / 6504lbs	no	5 pieces	
400	3150kg / 6945lbs	no	6 pieces	
400	3550kg / 7826lbs	no	8 pieces	

\* Above weight is indicative without options and without roller (except the power harrow machines).

\*\* Machines without power harrow can optionally be equipped with various other rollers.

\*\*\* The actual driving speed may vary depending on the application or situation.

ALL machines include: Walterscheid PTO shaft with Torque limiting clutch. Quick-change system for the spading blades (SX), LED lighting set and width warning signs.



# Digging the future

Imants BV  
Turnhousweg 29  
5541 NV REUSEL,  
The Netherlands  
Tel. +31 (0)497-642433

[www.imants.com](http://www.imants.com)  
[info@imants.com](mailto:info@imants.com)

KvK. 17154317  
VAT NL811935371B01

*The information in this brochure is subject to change. No rights can be obtained from the specifications. So always contact your imants representatives for advice.*

Dealer:

**imants**<sup>®</sup>  
Digging the future

SX-SERIES AGRICULTURE 202217040122